

THE INFORMATION CONTAINED HEREON IS THE PROPERTY OF PENTAIR WATER, INC. NO PORTION OF THIS DATA SHALL BE RELEASED, DISCLOSED, USED, OR DUPLICATED FOR USE IN PROCUREMENT OR MANUFACTURING WITHOUT SPECIFIC WRITTEN PERMISSION FROM PENTAIR WATER, INC.

COMPUTER GENERATED DOCUMENT.
MANUAL CHANGES NOT ALLOWED.

REVISIONS					
PCO	REV	DESCRIPTION	DRAWN BY	DATE	CHKD BY
	A.00	INITIAL DRAFT	AS	07/11/14	

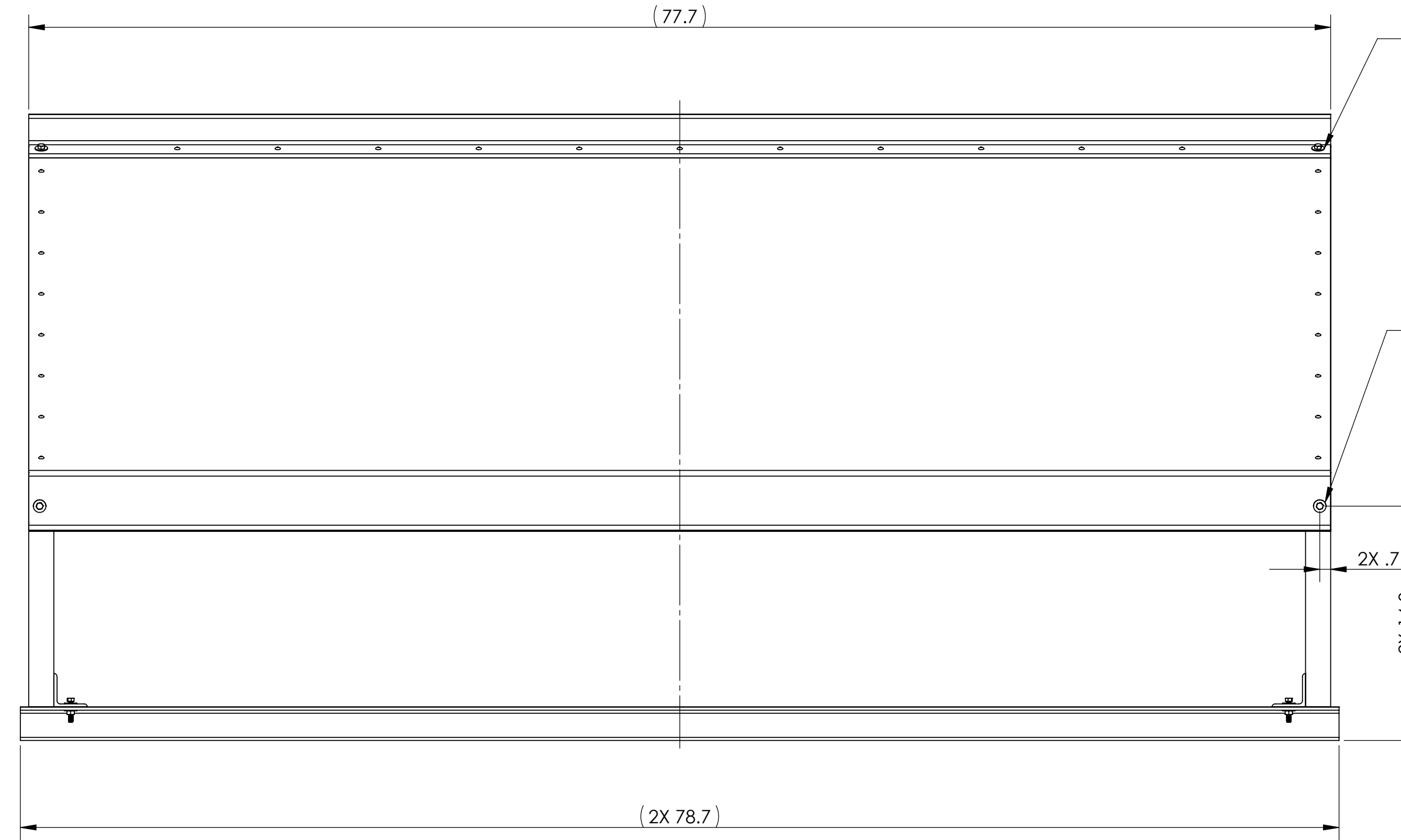
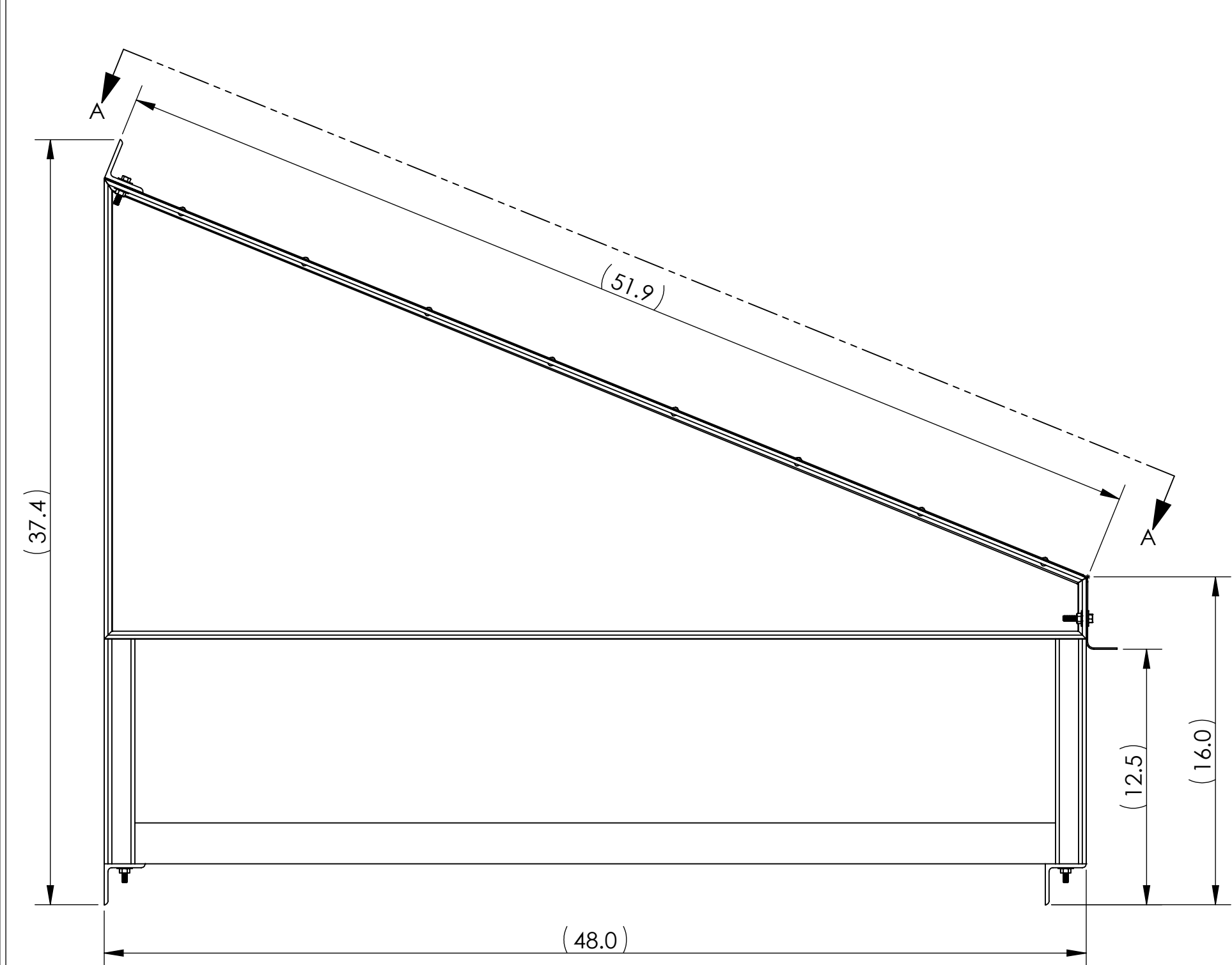

FOR NUT & BOLT FASTENING ON AL SHEET
CAPTURE THE DRILLING LOCATION FROM
ITEM NO. 5, DRILL SIZE - 9/32" THRU

FOR NUT & BOLT FASTENING
DRILL SIZE - 9/32" THRU

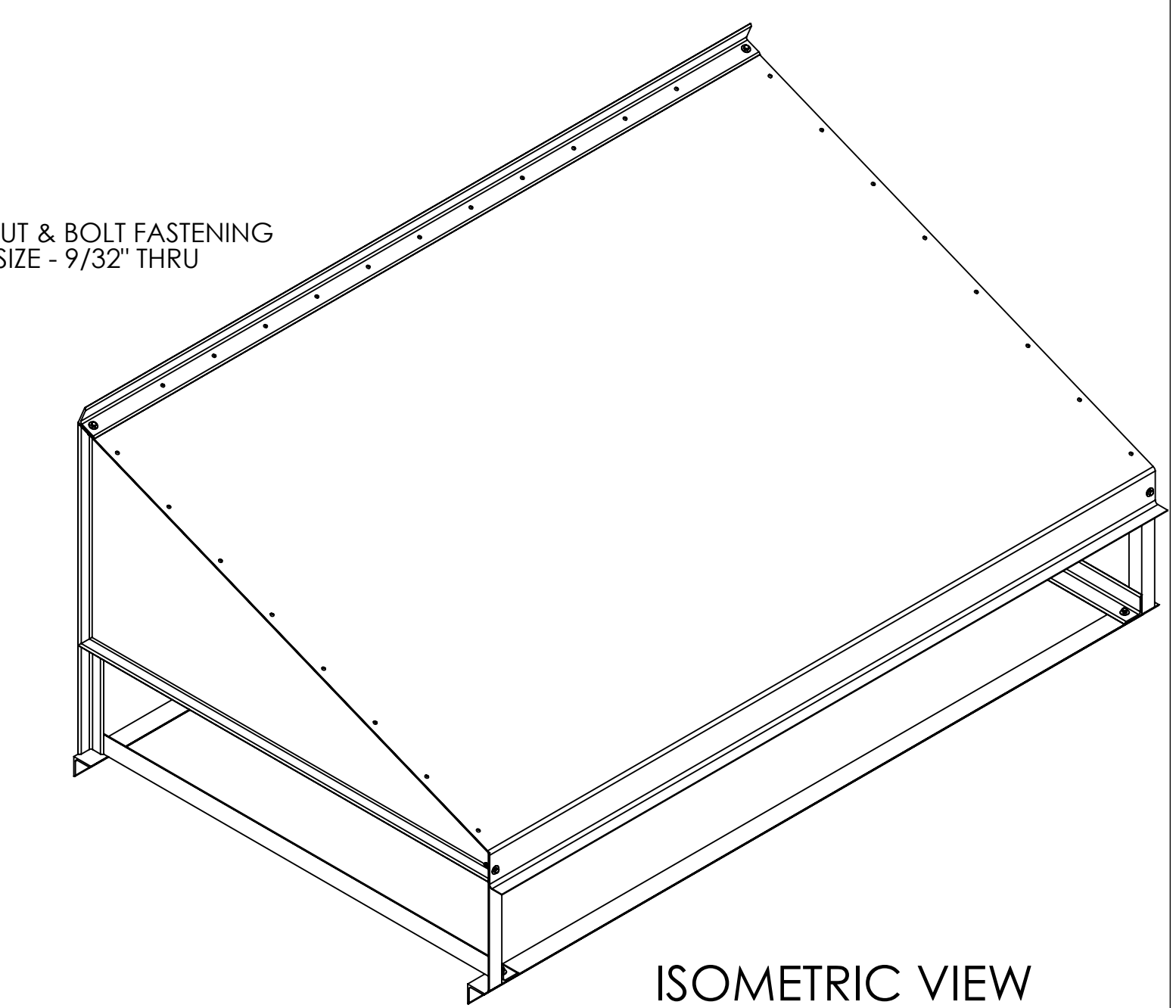

ISOMETRIC VIEW
SCALE 1 : 12

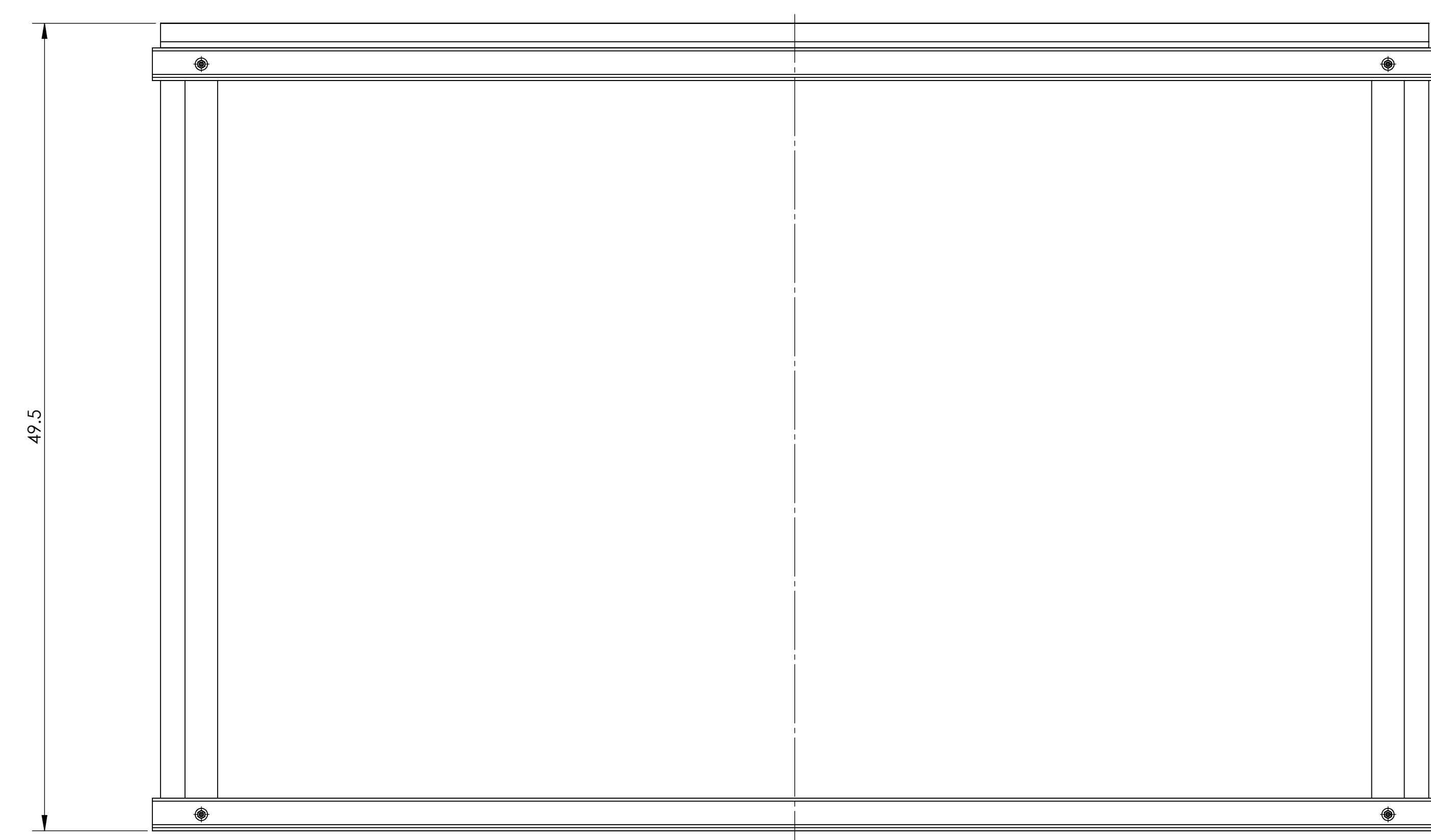

ANGLE SUMMARY		
ITEM	SECTION	LENGTH (FT.)
ANGLE	2" X 2" X 3/16"	29
ANGLE	1 1/2" X 1 1/2" X 3/16"	26

UNLESS OTHERWISE SPECIFIED:
 DIMENSIONS ARE IN INCHES
 TOLERANCES:
 .X OR X/X = ±1/64"
 .XX = ±.01"
 .XXX = ±.005"
 ANGULARITY: ±1°
 REMOVE ALL BURRS & BREAK SHARP EDGES .010" MAXIMUM EXCEPT P/L & SHUT OFFS. DIAMETERS TO BE CONCENTRIC WITHIN .005" T.I.R.

DO NOT SCALE DRAWING

PENTAIR
 AQUATIC ECO-SYSTEMS™
 2395 Apopka Blvd.
 Apopka, FL 32703

WHITE WATER UNIT - 2m

SIZE: DWG. NO. **D** XXXXXXXX
 SCALE: 1:6 WEIGHT: SHEET: 1 OF 4

REV. A.00

DATE: 7/10/14
 DRAWN: A SAINI
 CHECKED: XXXXXXXX
 SIGNATURES: _____
 SEE PCO FOR APPROVAL SIGNATURES

THIRD ANGLE PROJECTION

THE INFORMATION CONTAINED HEREON IS THE PROPERTY OF PENTAIR WATER, INC. NO PORTION OF THIS DATA SHALL BE RELEASED, DISCLOSED, USED, OR DUPLICATED FOR USE IN PROCUREMENT OR MANUFACTURING WITHOUT SPECIFIC WRITTEN PERMISSION FROM PENTAIR WATER, INC.

COMPUTER GENERATED DOCUMENT.
MANUAL CHANGES NOT ALLOWED.

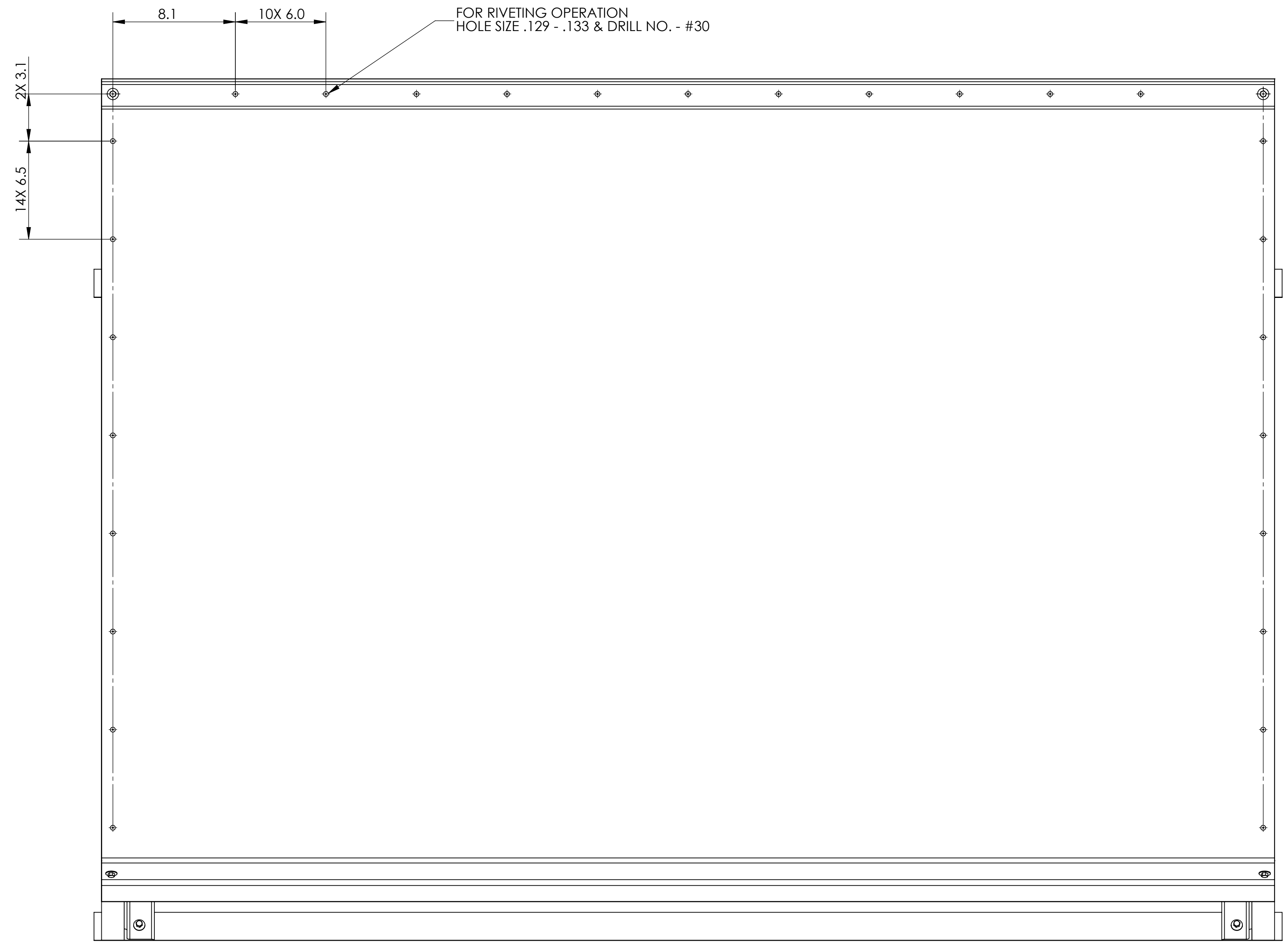
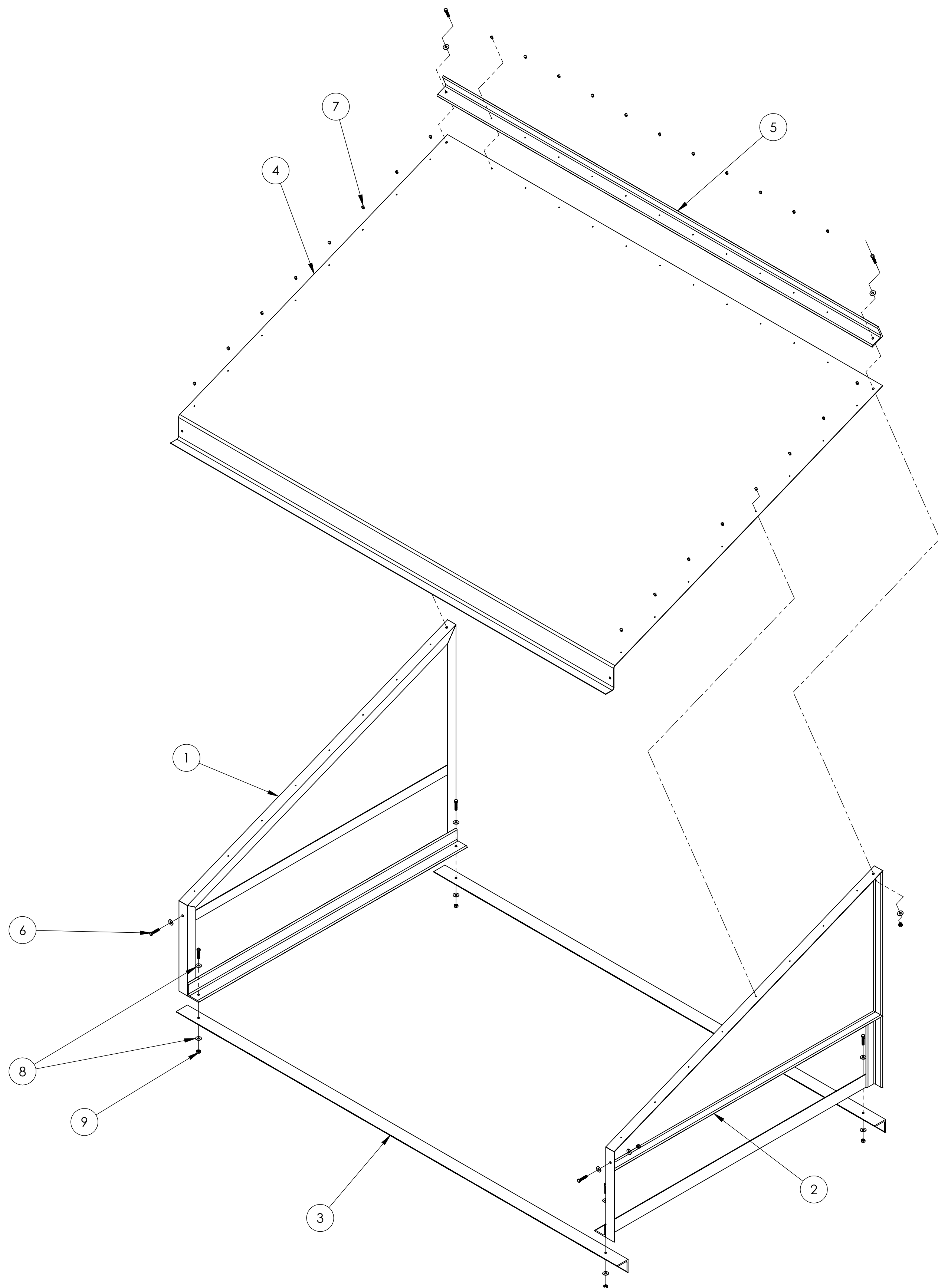

VIEW A-A
SCALE 1 : 5

9	8	HEX NUT, 1/4"-20 THD	A307, GRADE - A	GALVANIZED 1/4"-20, A307 HEX NUT, H.D.G	-
8	16	WASHER	A307, GRADE - A	GALVANIZED WASHER, OD-47/64", ID-5/16" FOR 1/4" BOLT	-
7	27	RIVET 1/8"	AL	NAIL TYPE BLIND RIVET - 1/8"	-
6	8	HEX BOLT	A307, GRADE - A	GALVANIZED 1/4" - 20X1" A307 - A HEX BOLT H.D.G	-
5	1	TOP ANGLE	6063-T6 ASTM B308 AL	ANGLE 2" X 2" X 3/16"	77.74
4	1	TOP COVER SHEET	14 GAUGE AL SHEET, GRADE - 5052	TOP COVER AL SHEET 14 GAUGE	-
3	2	BASE ANGLE	6063-T6 ASTM B308 AL	ANGLE 2" X 2" X 3/16"	78.74
2	1	WELDED FRAME RH	-	WELDED FRAME RH	-
1	1	WELDED FRAME LH	-	WELDED FRAME LH	-
ITEM NO.	QTY.	PART NUMBER	MATERIAL	DESCRIPTION	LENGTH

1. RIVETING AND THEIR HOLES SHOULD BE DONE ON ASSEMBLED FRAME AT SHOWN LOCATION .

NOTES: UNLESS OTHERWISE SPECIFIED



AQUATIC ECO-SYSTEMS™

SIZE: DWG. NO. D XXXXXXX

SCALE: 1:8 WEIGHT:

2395 Apopka Blvd.
Apopka, FL 32703

REV. A.00

SHEET: 2 OF 4

THE INFORMATION CONTAINED HEREON IS THE PROPERTY OF PENTAIR WATER, INC. NO PORTION OF THIS DATA SHALL BE RELEASED, DISCLOSED, USED, OR DUPLICATED FOR USE IN PROCUREMENT OR MANUFACTURING WITHOUT SPECIFIC WRITTEN PERMISSION FROM PENTAIR WATER, INC.

COMPUTER GENERATED DOCUMENT.
MANUAL CHANGES NOT ALLOWED.

**ITEM NO. - 1
WELDED FRAME LH**

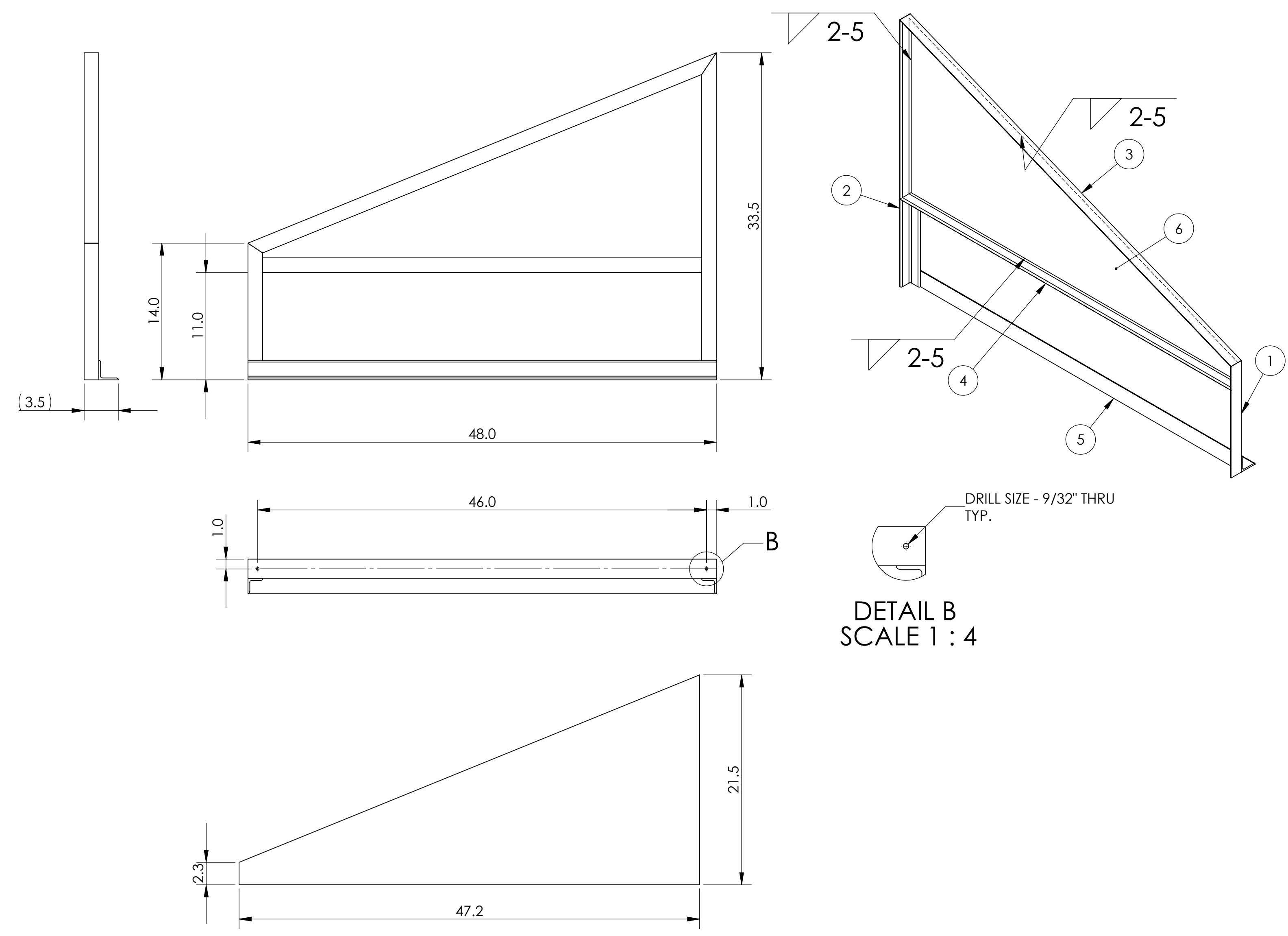

ELEMENT NO. - 6

ELEMENT NO.	QTY.	PART NUMBER	MATERIAL	DESCRIPTION	LENGTH
6	1	SIDE COVER SHEET	14 GAUGE AL SHEET, GRADE - 5052	SIDE COVER AL SHEET 14 GAUGE	-
5	1	BASE ANGLE	6063-T6 ASTM B308 AL	ANGLE 2" X 2" X 3/16"	48
4	1	MIDDLE ANGLE	6063-T6 ASTM B308 AL	ANGLE 1 1/2" X 1 1/2" X 3/16"	48
3	1	UPPER ANGLE	6063-T6 ASTM B308 AL	ANGLE 1 1/2" X 1 1/2" X 3/16"	51.8
2	1	BACK ANGLE	6063-T6 ASTM B308 AL	ANGLE 1 1/2" X 1 1/2" X 3/16"	33.5
1	1	FRONT ANGLE	6063-T6 ASTM B308 AL	ANGLE 1 1/2" X 1 1/2" X 3/16"	14

1. ALL ANGLES SHOULD BE WELDED ALL ROUND & CONTINUOUS WELD.
NOTES: UNLESS OTHERWISE SPECIFIED

**ITEM NO. - 2
WELDED FRAME RH**

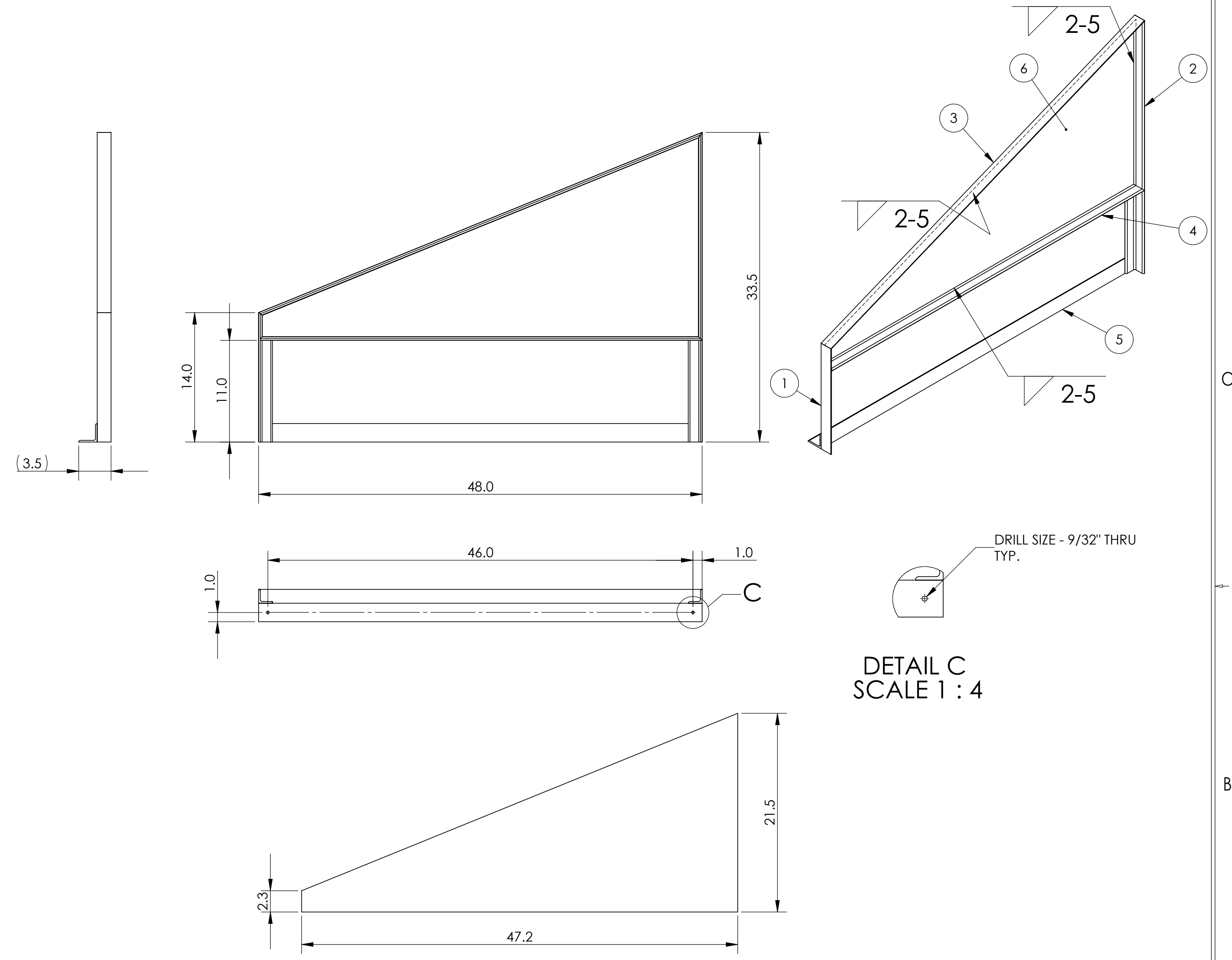

ELEMENT NO. - 6

ELEMENT NO.	QTY.	PART NUMBER	MATERIAL	DESCRIPTION	LENGTH
6	1	SIDE COVER SHEET	14 GAUGE AL SHEET, GRADE - 5052	SIDE COVER AL SHEET 14 GAUGE	-
5	1	BASE ANGLE	6063-T6 ASTM B308 AL	ANGLE 2" X 2" X 3/16"	48
4	1	MIDDLE ANGLE	6063-T6 ASTM B308 AL	ANGLE 1 1/2" X 1 1/2" X 3/16"	48
3	1	UPPER ANGLE	6063-T6 ASTM B308 AL	ANGLE 1 1/2" X 1 1/2" X 3/16"	51.8
2	1	BACK ANGLE	6063-T6 ASTM B308 AL	ANGLE 1 1/2" X 1 1/2" X 3/16"	33.5
1	1	FRONT ANGLE	6063-T6 ASTM B308 AL	ANGLE 1 1/2" X 1 1/2" X 3/16"	14

PENTAIR
AQUATIC ECO-SYSTEMS™
2395 Apopka Blvd.
Apopka, FL 32703
SCALE: 1:8 WEIGHT: SHEET: 3 OF 4

THE INFORMATION CONTAINED HEREON IS THE PROPERTY OF PENTAIR WATER, INC. NO PORTION OF THIS DATA SHALL BE RELEASED, DISCLOSED, USED, OR DUPLICATED FOR USE IN PROCUREMENT OR MANUFACTURING WITHOUT SPECIFIC WRITTEN PERMISSION FROM PENTAIR WATER, INC.

COMPUTER GENERATED DOCUMENT.
MANUAL CHANGES NOT ALLOWED.

ITEM NO. - 3

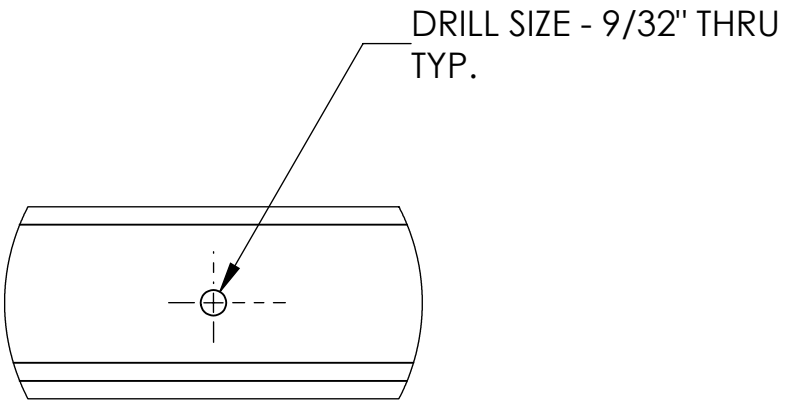
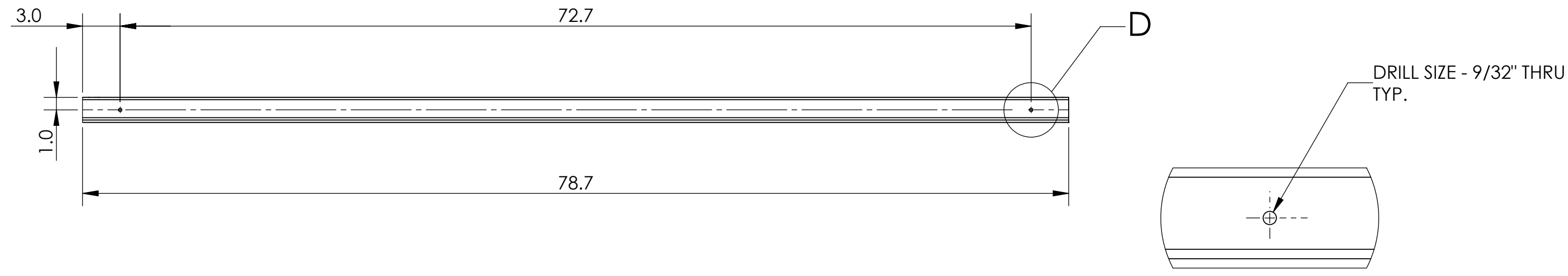

DETAIL D
SCALE 1 : 2

ITEM NO. - 5

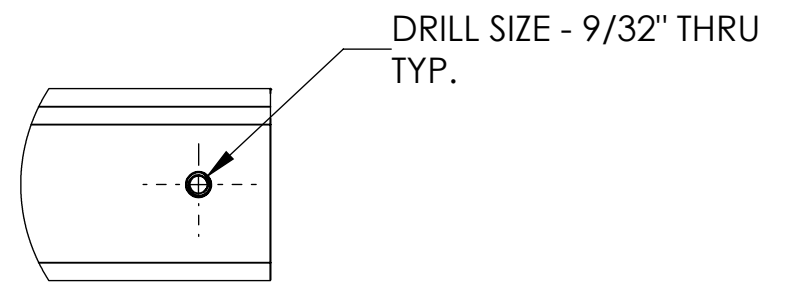
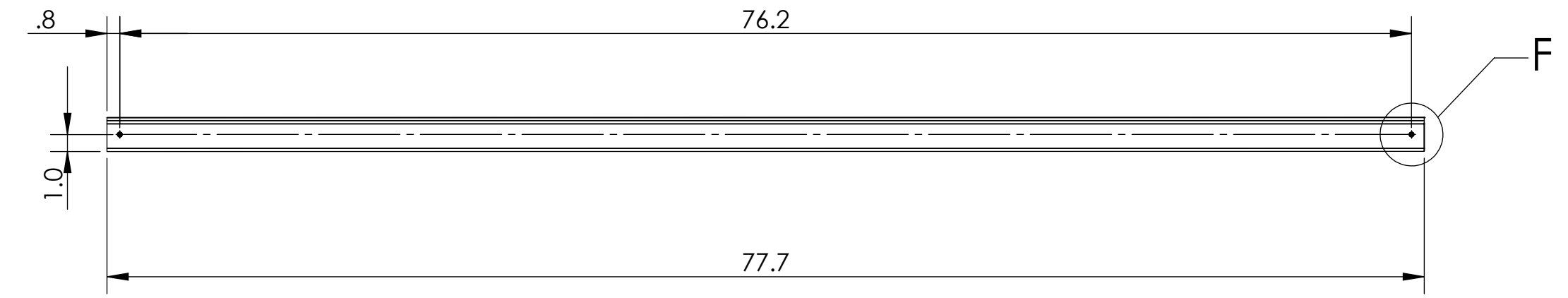

DETAIL F
SCALE 1 : 2

ITEM NO. - 4

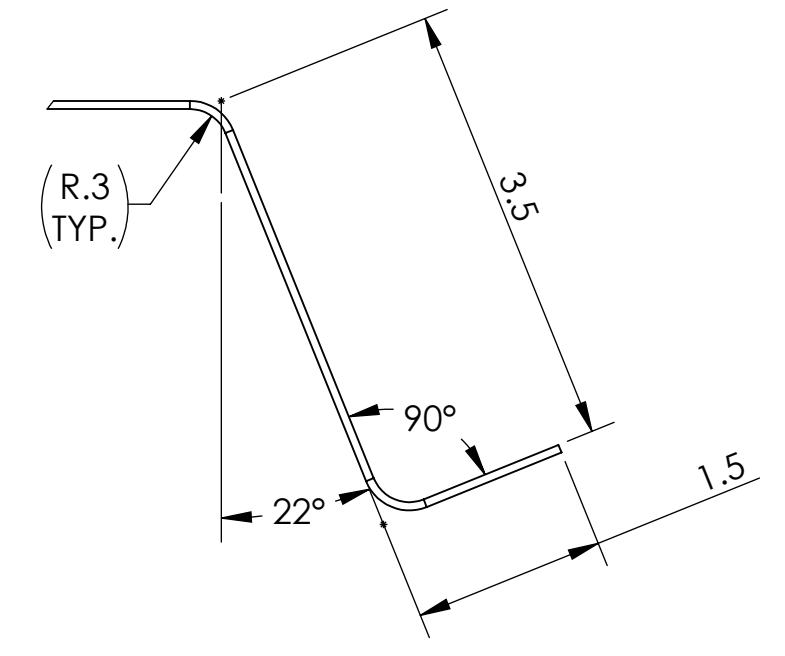
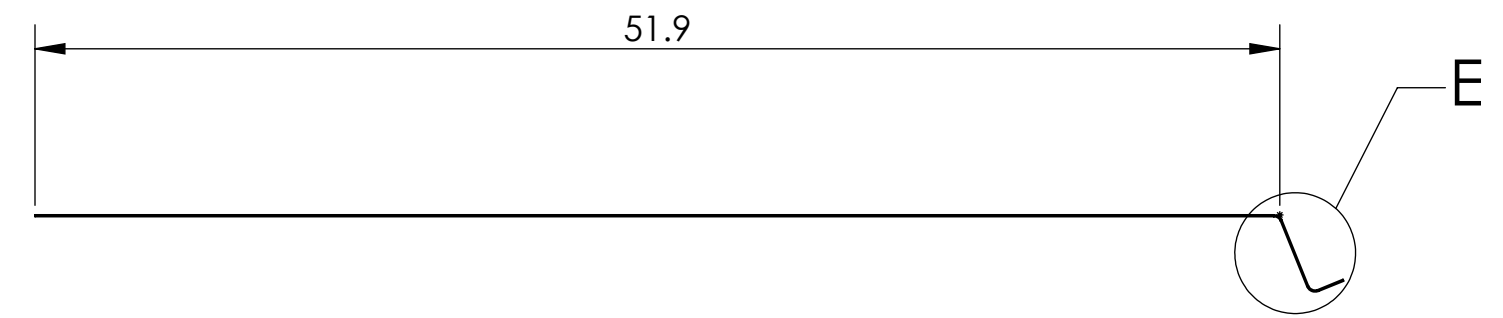
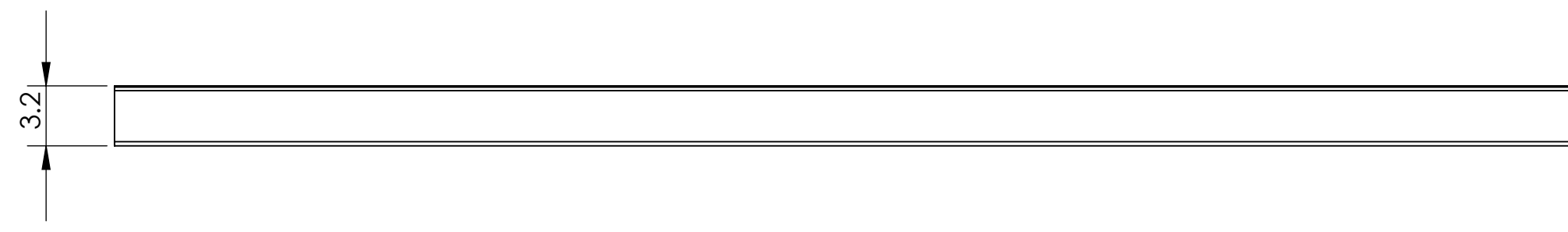

DETAIL G
SCALE 2 : 3

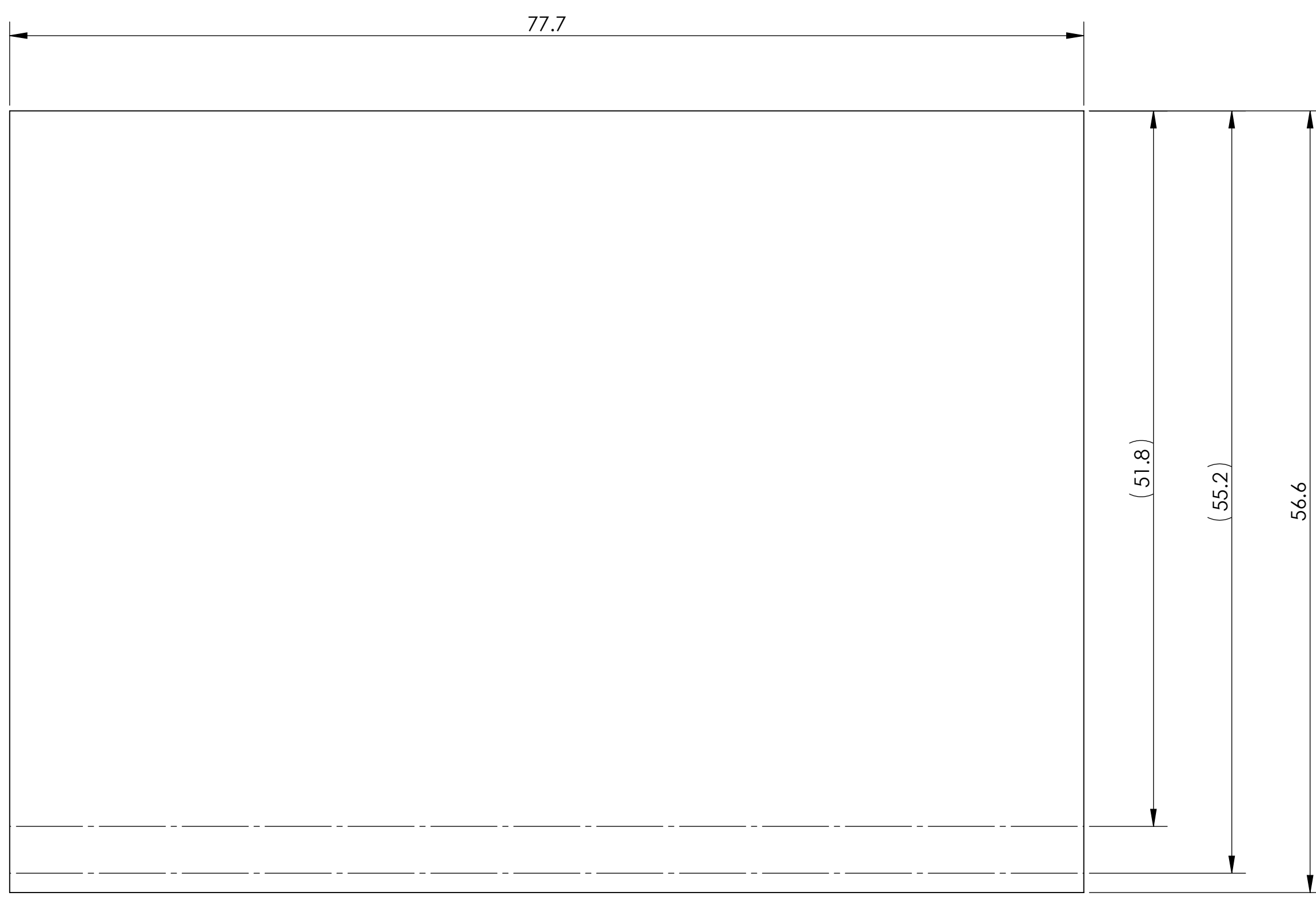

FLAT PATTERN

1. PROFILE OF ALUMINIUM SHEET TO BE MAINTAINED AS PER ASSEMBLED FRAME.
NOTES: UNLESS OTHERWISE SPECIFIED

PENTAIR
AQUATIC ECO-SYSTEMS™
2395 Apopka Blvd.
Apopka, FL 32703
SIZE: DWG. NO. D XXXXXXXX REV. A.00
SCALE: 1:8 WEIGHT: SHEET: 4 OF 4